

# Special Event Conceptual GIS & Draft Operations Plan

## Glen Helen Regional Park, San Bernardino County, CA

### Client

TEAMexpo, LLC  
 P.O. Box 669  
 Scotch Plains, NJ 07076

### Project Location

San Bernardino County,  
 CA

### Contact

Michael Frisch  
 908 / 889-6226

### Project Date

2005-2006

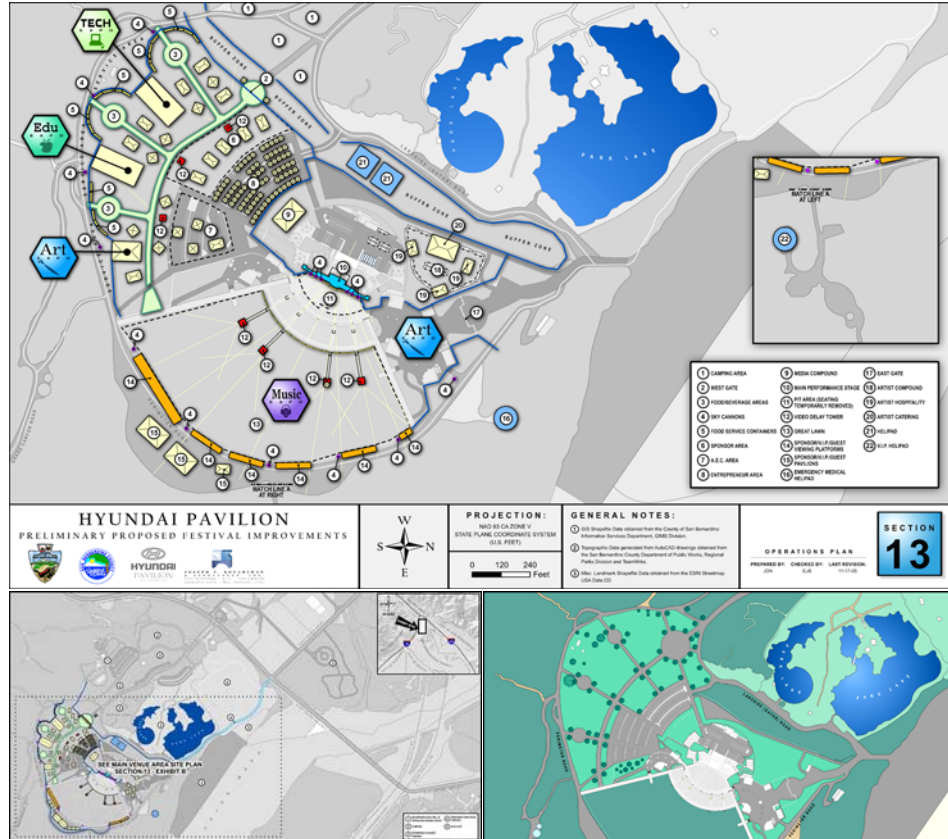

JBA prepared a conceptual GIS and draft Operations Plan for a proposed five-day technology, education, arts and music expo at Glen Helen Regional Park in San Bernardino County, CA. The conceptual GIS was utilized to produce various

and preliminary improvement plans for both Glen Helen Regional Park and the Hyundai Pavilion. JBA also provided Civil Engineering consulting services throughout the project.

### Key Project Staff

Edward J. Bonadiman, P.L.S. – *Project Manager*  
 Joseph S.C. Bonadiman, P.E. – *Quality Control/Project Oversight*  
 Jesse D. Nash – *G.I.S. Analyst*

